

1" 3-WAY BALL VALVE REPLACEMENT PARTS

063-0172-172

ITEM	DESCRIPTION	RAVEN PART #
1	Motor Assembly, Fast Valve	063-0172-146
2	1" 3 Way Ball Valve	334-0002-043
3	Bracket	107-0171-396
4	Washer Split Lock	313-1000-036
5	Screw, Cap #10-24 x 3/8"	311-0068-047
6	Coupler, 1" 3-Way	107-0171-397
7	Clamp, Coupler	107-0171-394
8	Screw, Cap, 1/4'20 x 1"	311-0068-068
9	Screw, Cap, 1/4-20 x 1/2"	311-0068-064
10	Washer, Split Lock	313-1000-017
11	Bolt, Hex, 1/4-20 x 1/2"	311-0050-201
12	Valve/Bracket Assembly	063-0172-152
13	Wiring Kit	117-0159-642

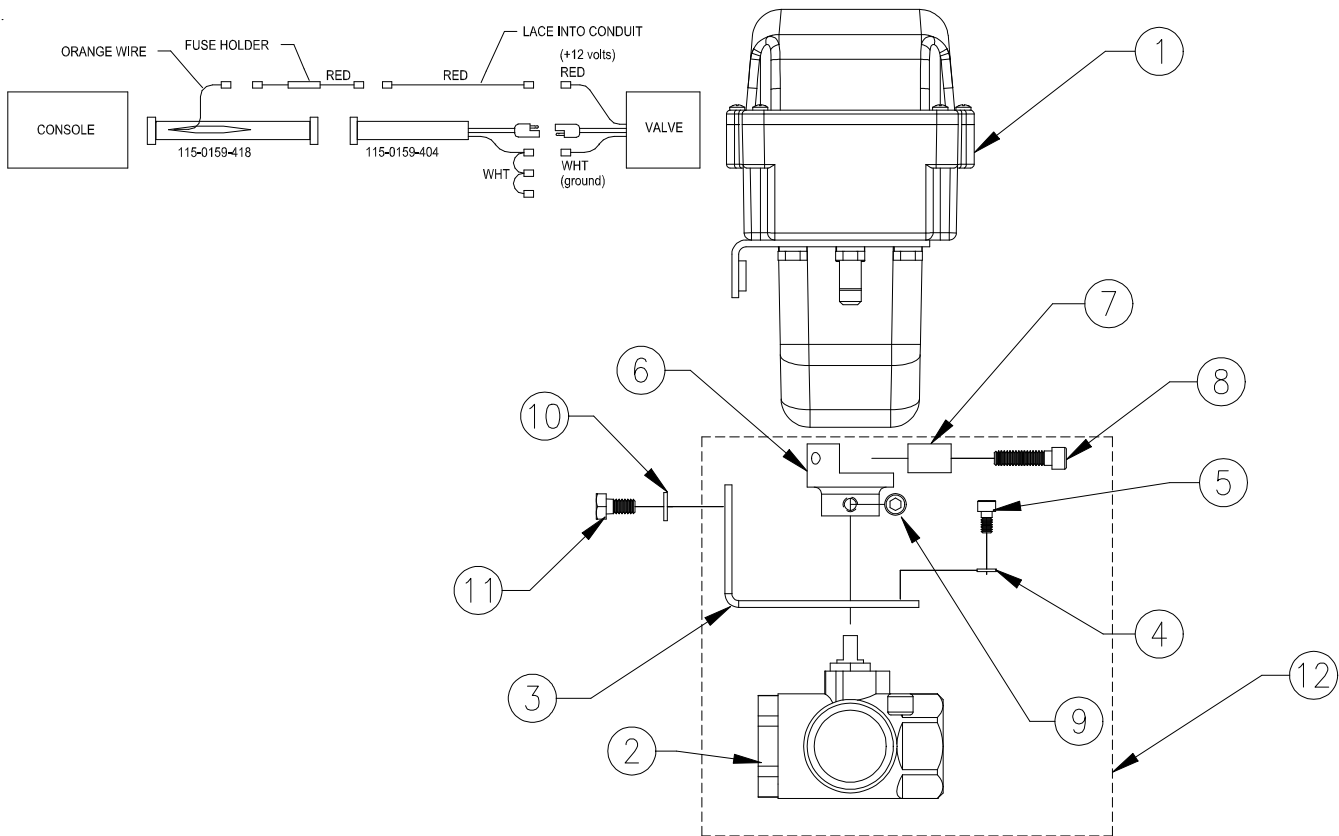

To Assemble:

1. Run motor assembly to fully closed position. Also, make sure valve is in bypass direction.
2. Assemble bracket to valve.
3. Thread coupler on ball valve the entire way, then back off (no more than 1 turn) until coupler is in position shown above. Tighten cap screw (item 9).
4. Assemble Valve/Bracket to motor assembly using items 10 & 11.
5. Tighten the two cap screws (item 8).