

# PowerGlide Plus to UltraGlide Valve Conversion

## Square Coil Valves

FIGURE 1. PowerGlide Plus to UltraGlide Valve Conversion

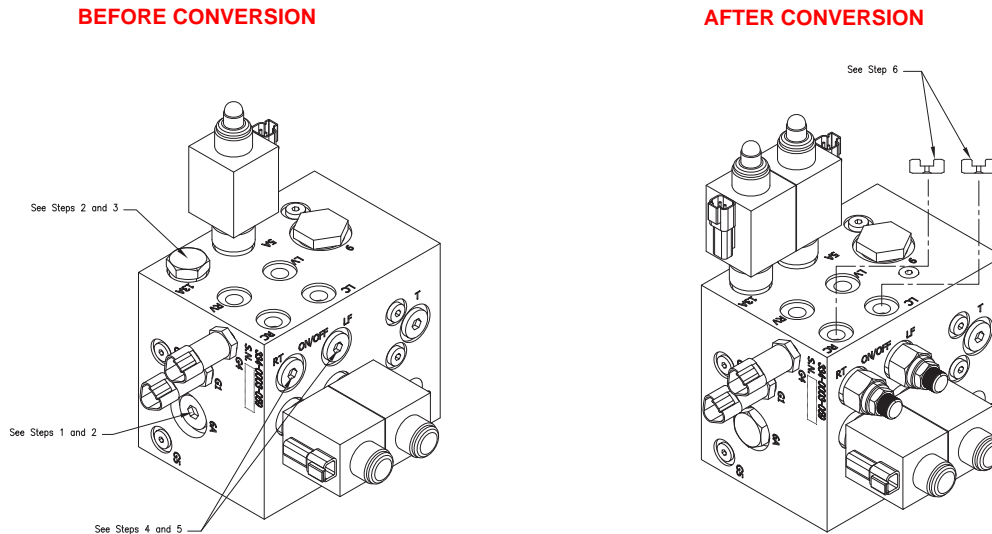

1. Remove the port plug from Port 6A.

**Note:** Keep the port plug for future use.

2. Remove the cavity plug from Port 13A and place it in Port 6A.
3. Install the pressure reducing valve (P/N 334-0002-069) in Port 13A.
4. Remove the port plugs from Ports RT and LF ON/OFF.

**Note:** Keep the port plugs for future use.

5. Install hydraulic needle valves (P/N 334-0002-071) in Ports RT and LF ON/OFF.
6. Loosen the jam nuts on the needle valves.
7. Using a hex key wrench, turn the set screws clockwise until they won't turn any further.
8. Tighten the jam nuts.
9. Install orifices (P/N 333-0002-204) into Ports LC and RC, flat side down.

---

## Round Coil Valves

FIGURE 2. PowerGlide Plus to UltraGlide Valve Conversion

---

**BEFORE CONVERSION**

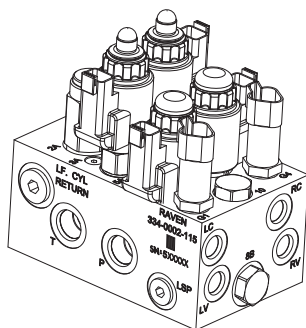

**AFTER CONVERSION**

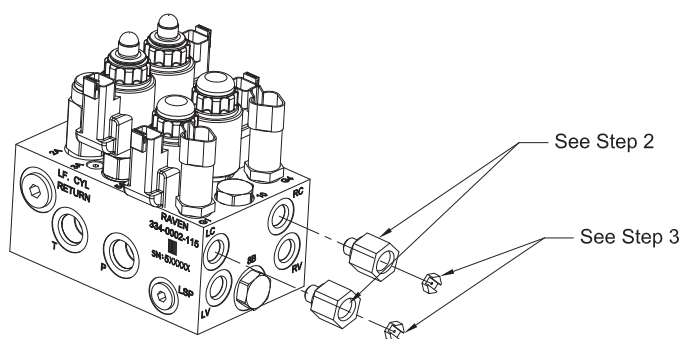

1. Remove the fittings from Ports LC and RC.
2. Install fittings (P/N 019-0159-504) into Ports LC and RC.
3. Install orifices (P/N 333-0002-204) in fittings installed in Ports LC and RC, with the flat side toward the valve.
4. Install the fittings removed in step 1 on the installed orifice fittings.