

# VIPER PRO WITH PHOENIX 200/300, SYSTEM OPTIONS, GVM LIQUID SPRAYER

- NOTES:**
1. THE SOLE PURPOSE OF THIS DRAWING IS TO PROVIDE PROPER DOCUMENTATION FOR INSTALLATION PURPOSES ONLY AND DOES NOT NECESSARILY DEPICT ACCURATE KIT CONTENTS.
  2. BATTERY POWER = CONNECT TO LIVE OR UNCLEAN SWITCHED POWER SOURCE.
  3. SWITCHED POWER = CONNECT TO CLEAN SWITCHED POWER SOURCE.

PHOENIX 300  
RECEIVER KIT  
117-0171-097

OR 117-0172-719  
PHOENIX 200  
KIT

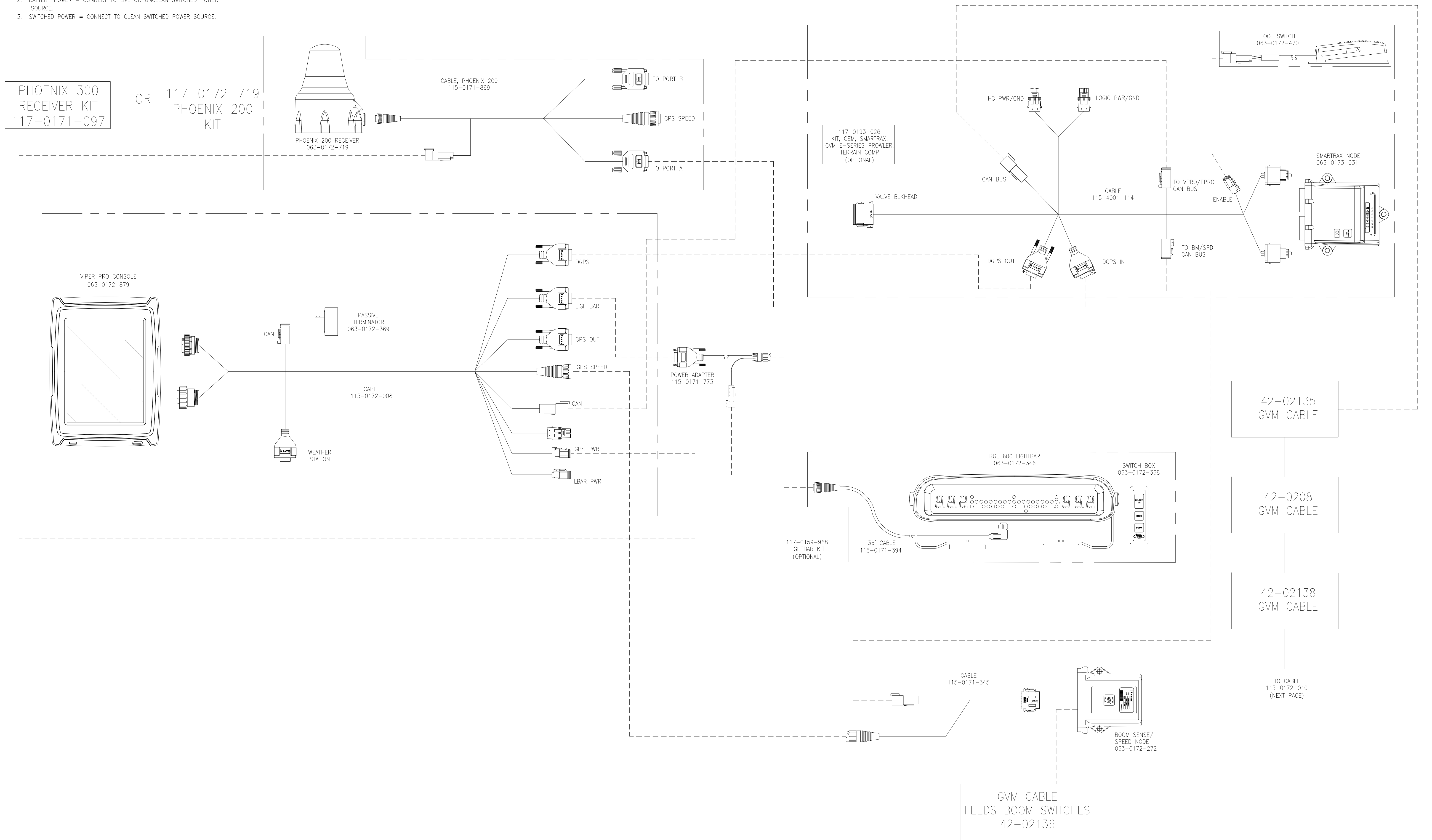

RELEASED DATE	ECO NO.	PROD. MGR.	SERV.	PROD. CHAMP.	ENG.	DRAFT.	REV.	DRAWING NO.
10/17/13	E19364	SSS	AT	N/A	TLB3	LJP	A	054-3800-001

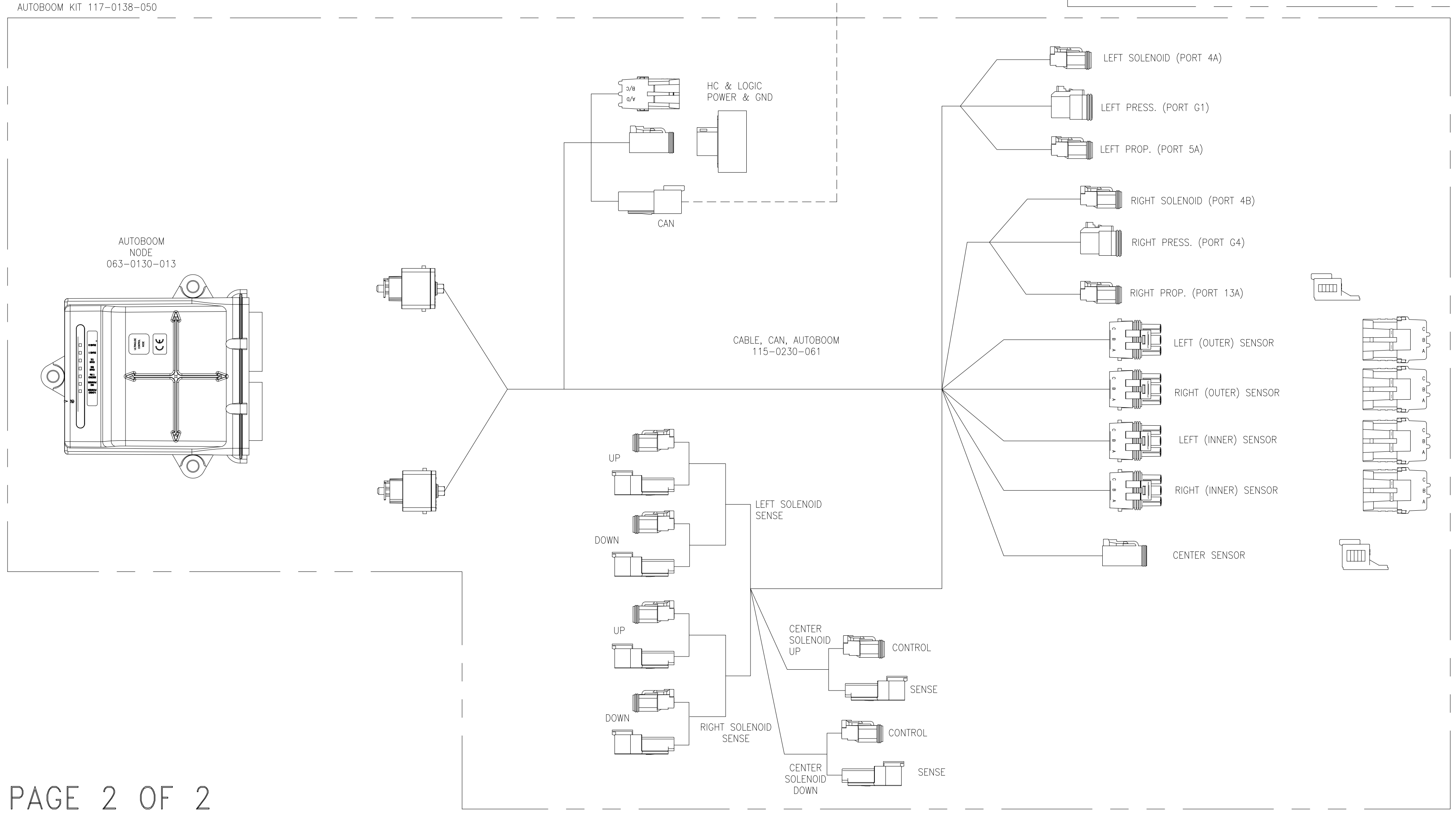
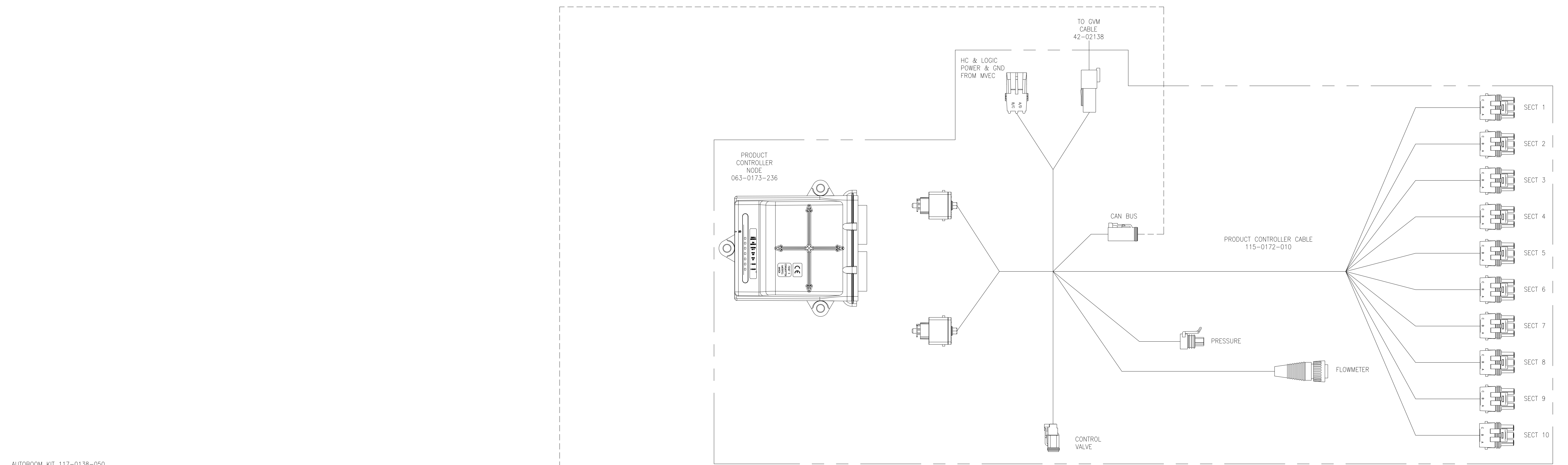

RELEASED DATE	ECO NO.	PRD. MGR.	SEV.	PRD. CHAMP.	ENG.	DRAFT.	REV.	DRAWING NO.
10/1/13	E19364	SSS	AT	N/A	TLB3	WJP	A	054-3800-001