

SET UP FIELD BOUNDARY

From the main run screen, select the **Menu** button  then the **Boundary Functions** button. Select the **Record** button.

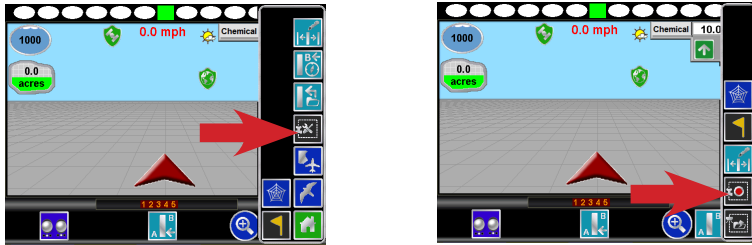

RECORD FIELD BOUNDARY

The Envizio Pro will start recording GPS points as soon as the machine starts moving. You can change the view perspective by selecting the **Menu** button and then selecting either the **Field Review** or **Down Field** buttons (optional). The recording process will auto complete when the machine's GPS location is one complete boom/implement width from the starting point.

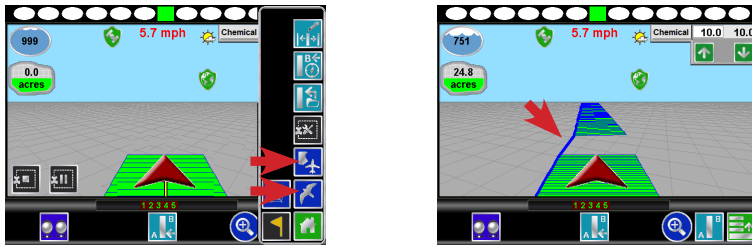

RECORD FIELD BOUNDARY WITH BUFFER ZONE

The Envizio Pro can also record a field boundary with a no-spray buffer zone around the field. On the **Start Job - Verify Settings** page, select the **AccuControl** button. Select **Enable Zone Map** and select the **Touch to create new** button. Enter a name for the new **Spray Zone Map** and continue with the rest of the job set up.

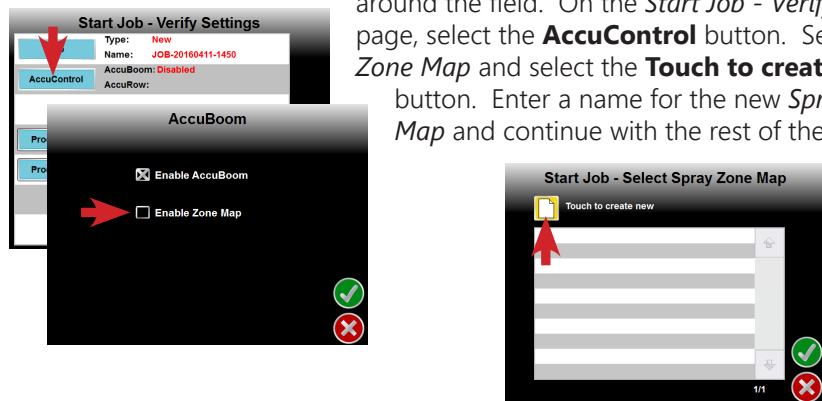

RECORD FIELD BOUNDARY WITH BUFFER ZONE (CONT.)

Select the **Menu**, **Boundary Functions** buttons as before. The **Menu Options** now offer field boundary, spray zone and no spray zone.



Select the **Field Boundary** button and then the **Recording Reference Point**. **The recording process will need to be stopped manually.** When ready to stop recording, select the **End Recording** button. The regular field boundary (without buffer zone) recording can be stopped in this manner too before the auto complete process finishes. To save the field boundary, select the **Menu** button then the **Save** button. 

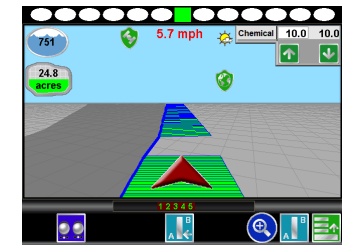
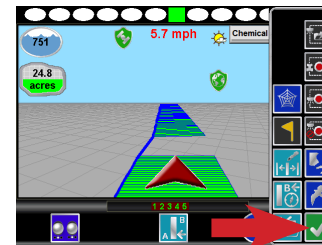
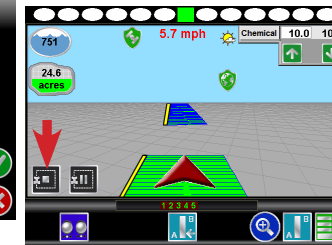
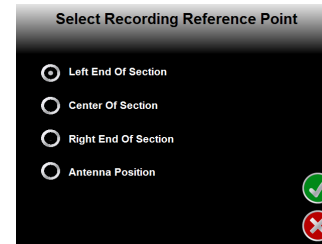

The buffer zone is not created until the field boundary is saved!