

JOB SCREEN

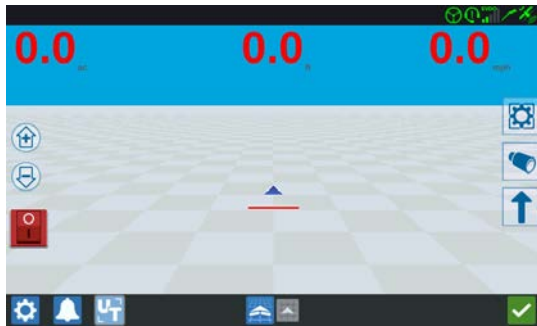

	zoom in		down field/field review
	zoom out		end job
	settings		configure widgets
	alarms		scout features
	universal terminal (UT)		guidance lines

LOAD A WIDGET

Select the **Configure Widgets** button to see the available widgets. You can scroll through the entire selection.

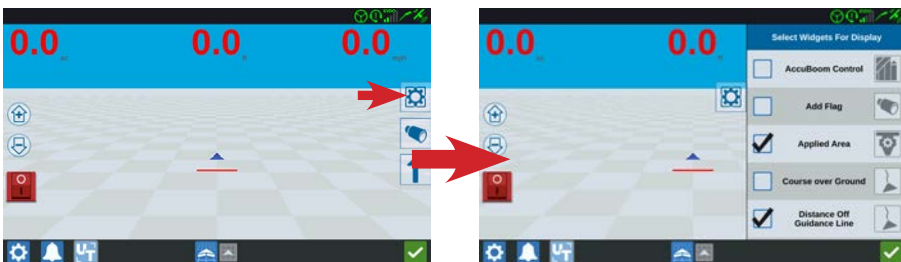

LOAD A WIDGET CONTINUED

Select the widget you want to load.



Press and hold on the crosshair indicator and move the widget to where you want to place it. Remove your finger and press on the crosshair indicator again to lock the widget in place.

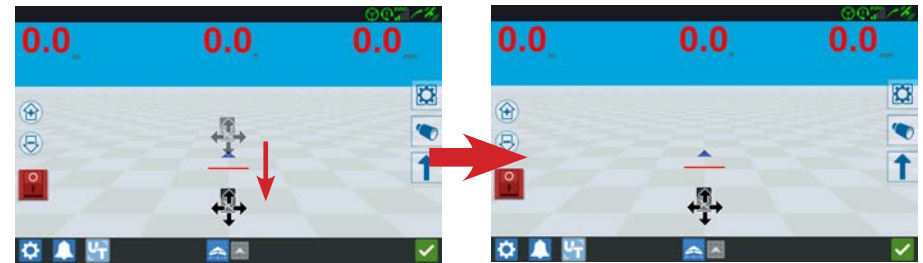

WIDGETS

WIDGET OPTIONS

Pressing and holding on a widget a second time will show additional options.

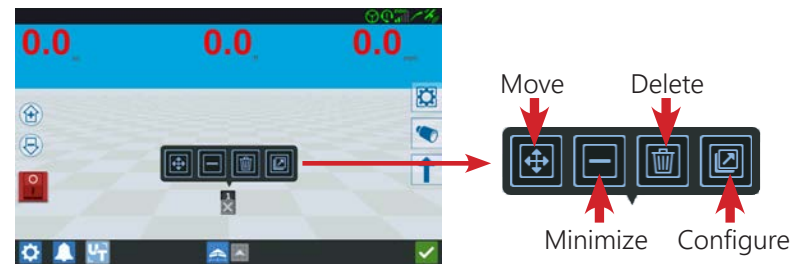

Not all widgets will have the same set of options.

MOVE A WIDGET

Press and hold on a widget to display the options. Select the **Move** button and drag the widget to where you want it. Remove your finger and press on it again to lock its location.



MINIMIZE A WIDGET

Press and hold on a widget to display the options. Select the **Minimize** button.

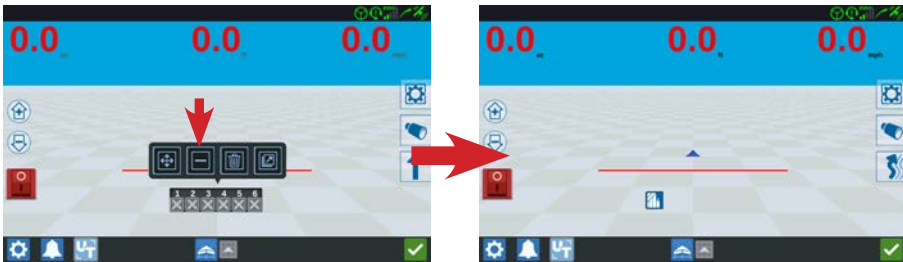

To maximize a minimized widget, press on it again.



DELETE A WIDGET (METHOD 1)

Press and hold on a widget to display the options. Select the **Delete** button.



DELETE A WIDGET (METHOD 2)

Select the **Configure Widgets** button and uncheck the widget you would like to remove.



CONFIGURE WIDGET SETTINGS

Some widgets have additional settings. Press and hold on a widget to display the options. Select the **Configure** button if available. You can now set or change the settings for that widget. Select the **Okay** button when finished.

