

SETTINGS PAGE

Select the **Settings** button.

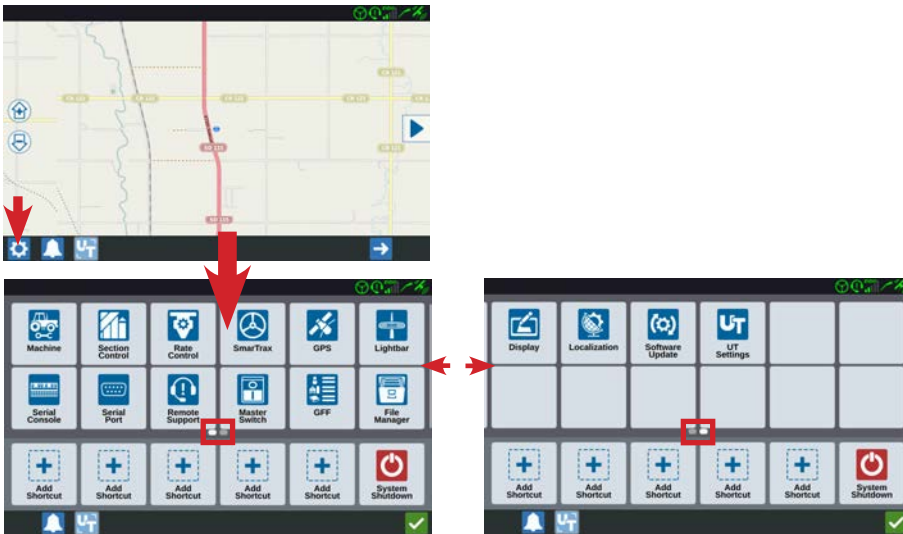

To see the other settings, slide the settings page either left or right.

ADD SHORTCUT

You can add commonly used settings to your *Shortcuts* section. Select one of the **Add Shortcut** buttons and then select the setting you want to place there.



DELETE SHORTCUT

You can remove a shortcut by selecting the shortcut you want to delete and then selecting the small **Delete** button that appears on the shortcut.



SETUP ORDER

This is just a suggested order for basic setup. It is more important that these items are configured before operation. Your CR7™ will walk you through some of these settings on first start up. Please verify these settings and configure the additional ones as needed.

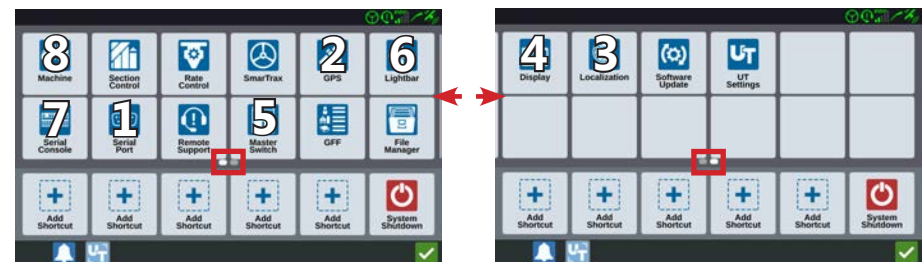

1. SERIAL PORT

Your CR7™ will auto detect your Raven 500S™ or 600S™ receiver. If GPS is not detected then you can choose *Port A* and select the **Detect Device** button. After detection, your GPS receiver will be listed in the *Device/Device Type* section.

If your receiver is still not detected then make sure it has correct power. The receiver also needs to be connected to the round 3-pin *GPS Receiver* connection on specific CR7™ cabling or the 9-pin *Com1/DGPS* connection if adapting to previous Raven field computer cabling.

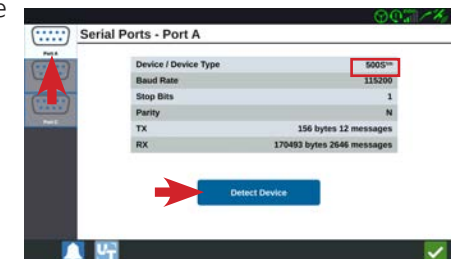

2. GPS

If your CR7™ is connected to a Raven 500S™/600S™ receiver, you can configure the differential settings. It is recommended to keep it in *Auto* unless directed otherwise. The other COM ports should not have to be configured. You can also see additional satellite information by selecting the **Information** button.

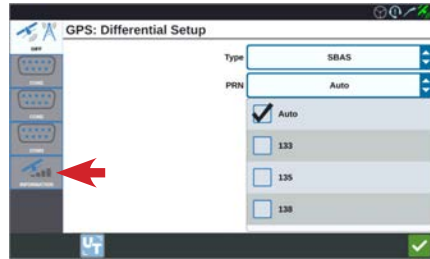

3. LOCALIZATION

You can configure your *Language*, *Time Zone* and application units in this section. You can select any combination of units based on your application needs.

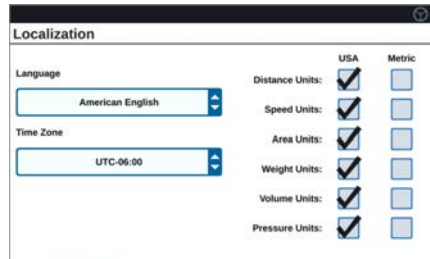

4. DISPLAY

You can configure two custom presets (**Day Mode** and **Night Mode**) for your *Screen Brightness* and *Lightbar Brightness*. The *Lightbar Brightness* setting affects the brightness of both the integrated lightbar (along the top of your CR7™) and an external lightbar if connected.

You can switch between **Day Mode** and **Night Mode** at any time by coming back to this page or loading the specific widget to your job screen.

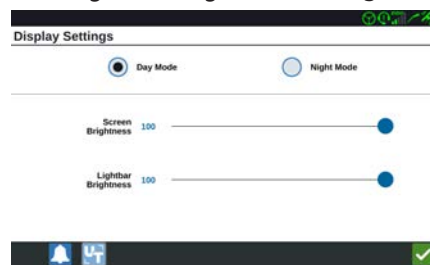

5. MASTER SWITCH

You can connect an external or implement switch to your CR7™ as well as use the **Master Switch** widget to activate coverage mapping. You can also set how these different switches will be used together or separately depending on your needs.



Master Switch widget

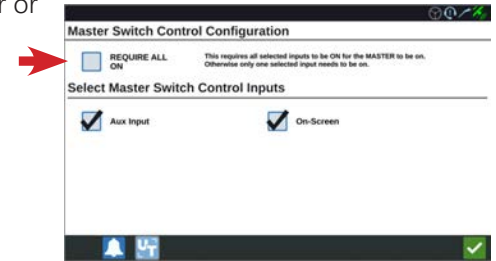

6. LIGHTBAR

You can configure when your offline indicators (along the top of your CR7™ or external lightbar) will turn red based on your choice of sensitivity (*Fine* to *Coarse*).

You can also reverse the indication if desired.

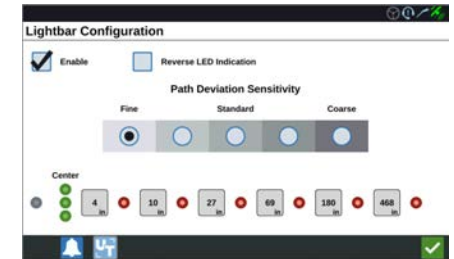

7. SERIAL CONSOLE

If your CR7™ is connected to a Raven serial console (SCS4xx or SCS6xx), you will need to set or verify your *Units*, *Scale factor*, and your *Base Units* since this information is not transferred from your serial console to your CR7™. The settings can generally be left at default as shown.

Please see the *CR7™ Serial Console* guide for additional information in setting your units correctly when doing product control.

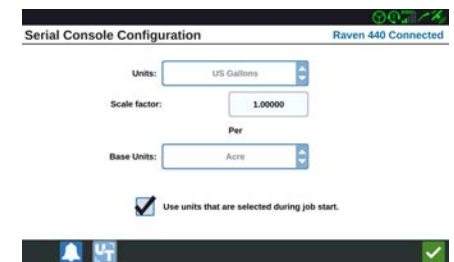

8. MACHINE

If you did not set up your machine in the set up wizard, you can do it here. Select the **New Configuration** button and continue with your machine set up. Please see the *CR7™ Measurement Checklist* and the *CR7™ Machine Set Up* guides for more information.

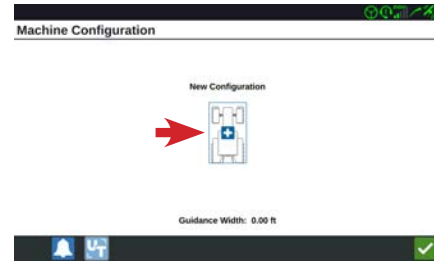

If you have moved your CR7™ into another machine, you will need to add your new machine measurements. Just select the **Reset** button and then create your new machine as you did with your prior one.

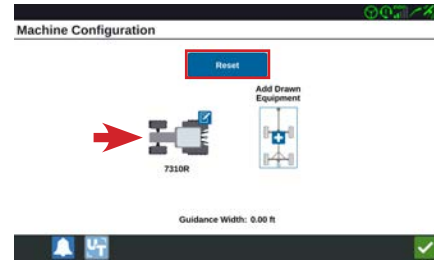

If you just need to update machine measurements then select the machine **Edit** button.